

© Crown Copyright. All rights reserved. Croydon Council, Licence No: 100019257 2010

CROYDON COUNCIL

AMBERLEY ROAD - CROYDON

Proposed "At Any Time" Waiting Restrictions

| | | | |
|--------------------------------------|--|---------------------------------|--|
| DEVELOPMENT & ENVIRONMENT DEPARTMENT | | INFRASTRUCTURE - TRAFFIC DESIGN | |
| JO NAGRINI - EXECUTIVE DIRECTOR | | Checked DJW | |
| PO BOX No. 1462 | | Rev. 00 | |
| CROYDON | | Drawing Ref. | |
| CR9 1WX | | PD 239a | |
| Date: | | Date: | |
| JUL Y 2014 | | JUL Y 2014 | |



**PROPOSED WAITING RESTRICTIONS AT
THE JUNCTIONS OF APSLEY ROAD**

CROYDON COUNCIL
APSLEY ROAD

| | | | |
|--|--|---------------------------------|--------------|
| DEVELOPMENT AND ENVIRONMENT DEPARTMENT | | INFRASTRUCTURE - TRAFFIC DESIGN | |
| JO NAGRINI - EXECUTIVE DIRECTOR | | Scale: 1:1000 | Drawn: HA |
| PO BOX No. 1482 | | Date: JULY 2014 | Checked: DJW |
| CROYDON | | CR9 1WX | Rev: 00 |
| | | Drawing Ref: | PD 239V |

© Crown Copyright. All rights reserved. Croydon Council. Licence No. 100019257 2010



Tennis Courts

Pavilion

© Crown Copyright. All rights reserved. Croydon Council, Licence No: 100019257 2010

**PROPOSED WAITING RESTRICTION
AT THE BEND IN BARMOUTH ROAD**

CROYDON COUNCIL

BARMOUTH ROAD

| | | | |
|--|--|---------------------------------|--|
| DEVELOPMENT AND ENVIRONMENT DEPARTMENT | | INFRASTRUCTURE - TRAFFIC DESIGN | |
| JO NAGRINI - EXECUTIVE DIRECTOR | | Drawn HA | |
| PO BOX No. 1482 | | Checked DJW | |
| CROYDON | | Rev. 00 | |
| CR9 1WX | | Drawing Ref. PD 239W | |
| | | Date: JULY 2014 | |

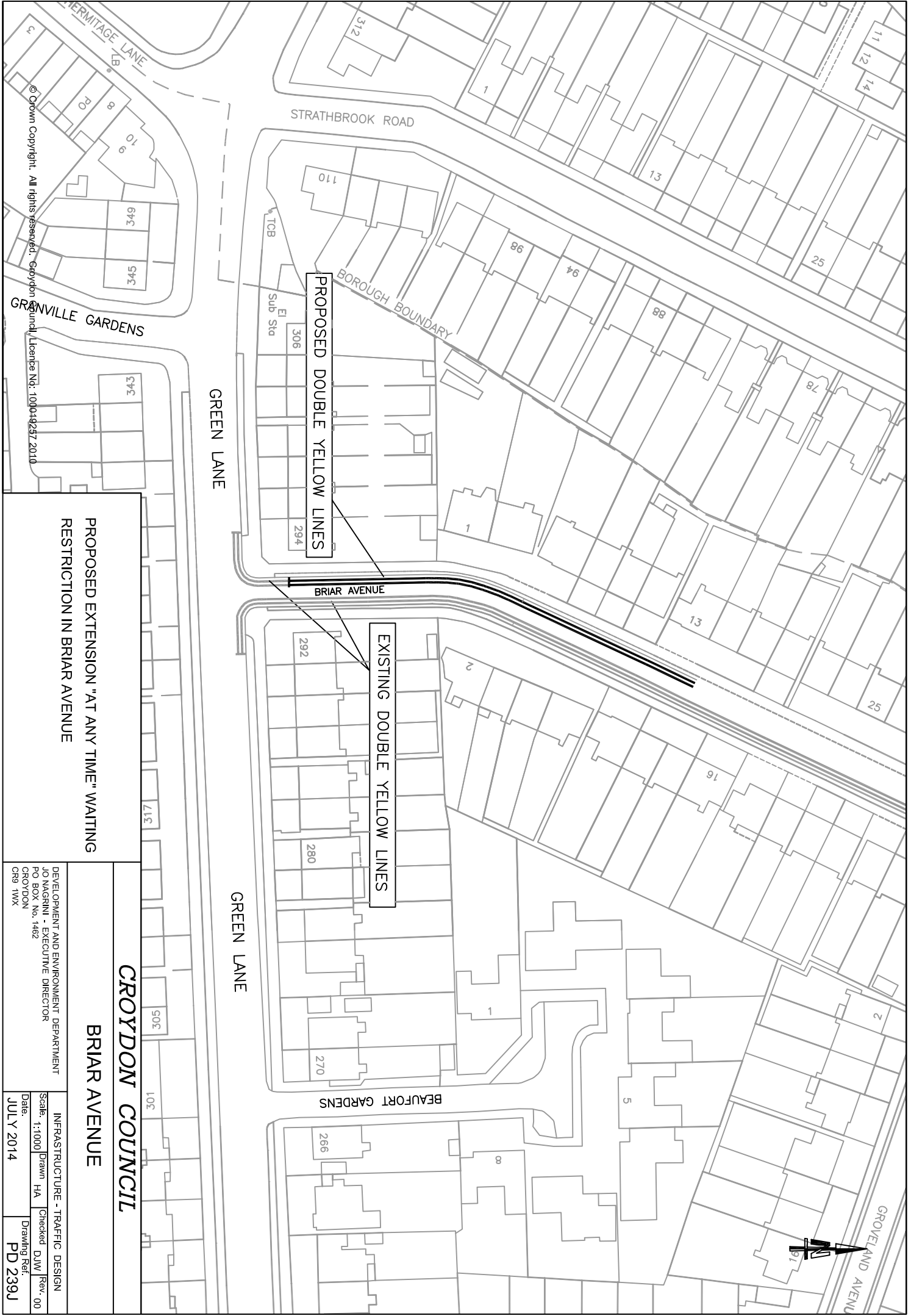

© Crown Copyright. All rights reserved. Geopydon Council Licence No. 100014257 2010

PROPOSED EXTENSION "AT ANY TIME" WAITING RESTRICTION IN BRIAR AVENUE

| | |
|--|---------------------------------|
| CROYDON COUNCIL | |
| BRIAR AVENUE | |
| DEVELOPMENT AND ENVIRONMENT DEPARTMENT | |
| JO NAGRINI - EXECUTIVE DIRECTOR | |
| PO BOX No. 1482 | |
| CROYDON | |
| CR9 1WX | |
| Scale: 1:1000 | INFRAStructure - TRAFFIC DESIGN |
| Date: JULY 2014 | Drawn: HA |
| | Checked: DJW |
| | Rev: 00 |
| | Drawing Ref: PD 239J |

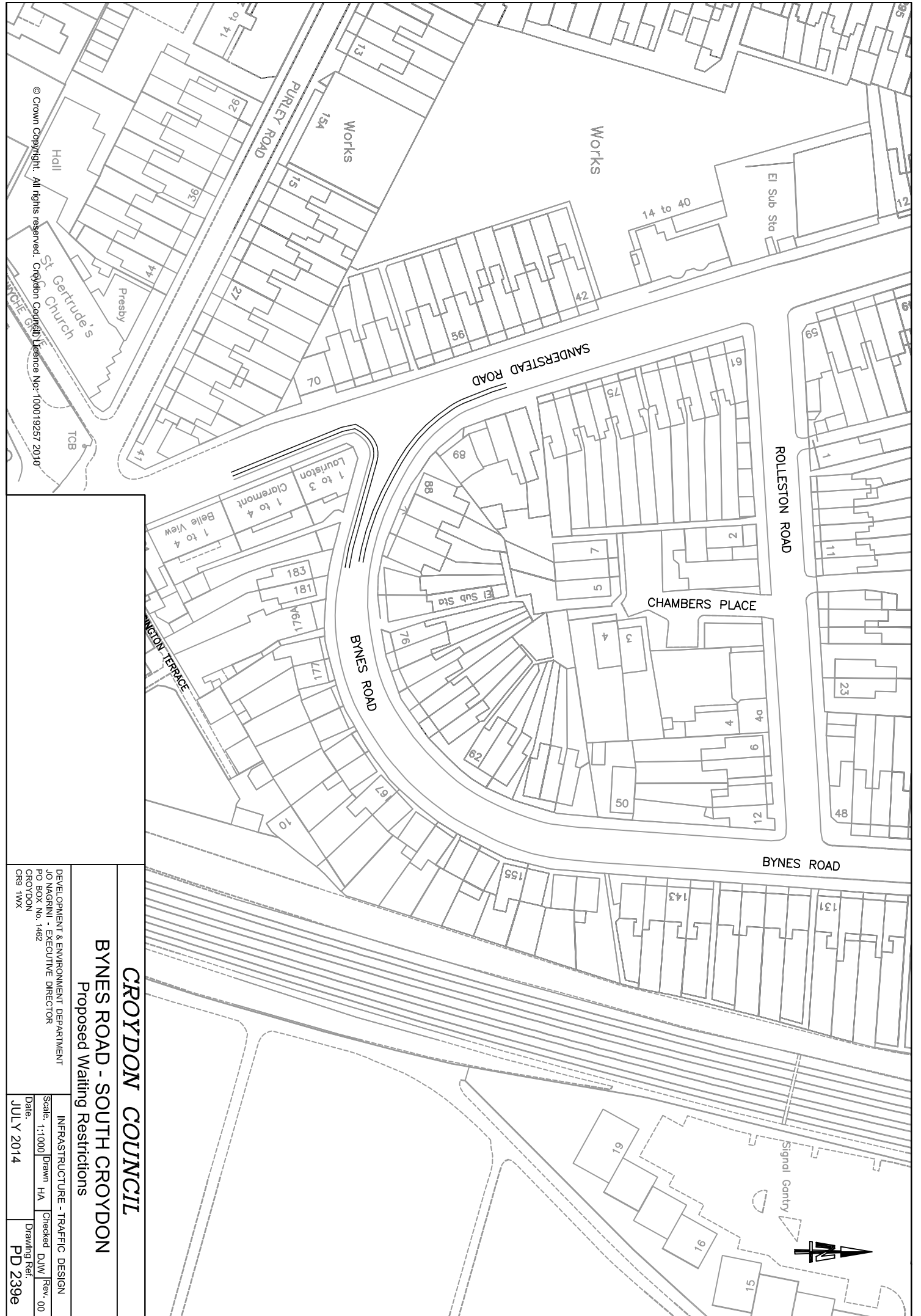

© Crown Copyright. All rights reserved. Croydon Council Licence No: 100019257 2010

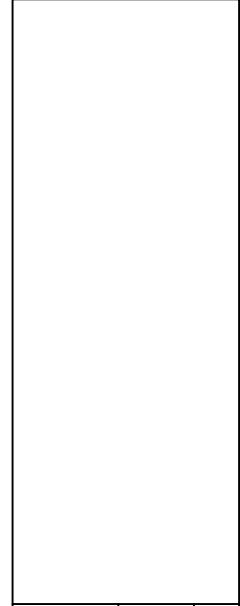

| | |
|--------------------------------------|----------------------|
| CROYDON COUNCIL | |
| BYNES ROAD - SOUTH CROYDON | |
| Proposed Waiting Restrictions | |
| DEVELOPMENT & ENVIRONMENT DEPARTMENT | |
| JO NAGRINI - EXECUTIVE DIRECTOR | |
| PO BOX No. 1462 | |
| CROYDON | |
| CR9 1WX | |
| Scale: 1:1000 | Drawn: HA |
| Date: JULY 2014 | Checked: DJW |
| | Rev: 00 |
| | Drawing Ref: PD 239e |

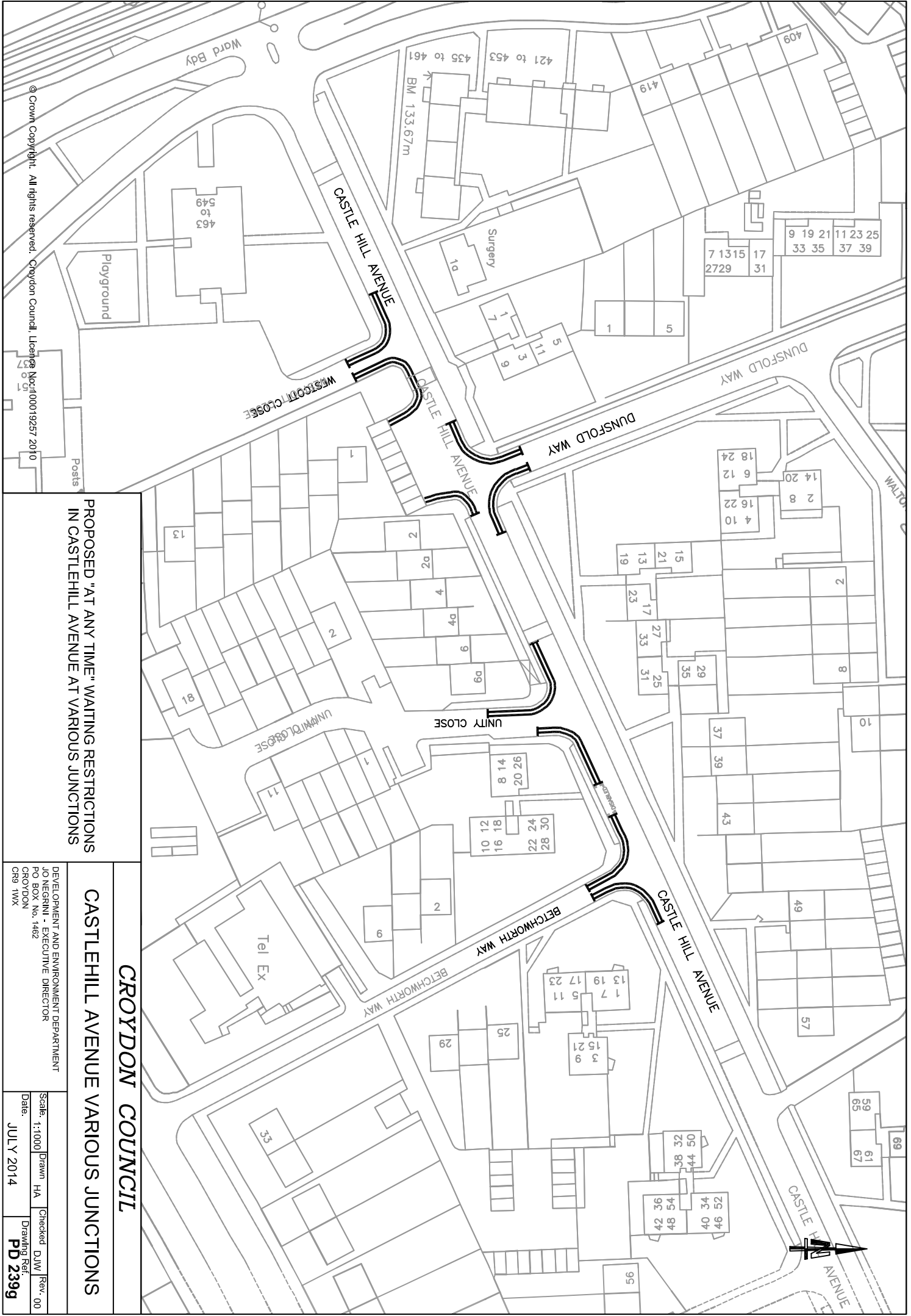

© Crown Copyright. All rights reserved. Croydon Council. Licence No: 100019257 2010

**PROPOSED "AT ANY TIME" WAITING RESTRICTIONS
IN CASTLEHILL AVENUE AT VARIOUS JUNCTIONS**

CROYDON COUNCIL

CASTLEHILL AVENUE VARIOUS JUNCTIONS

DEVELOPMENT AND ENVIRONMENT DEPARTMENT
 JO NEGRINI - EXECUTIVE DIRECTOR
 PO BOX No. 1462
 CROYDON
 CR9 1WX

| | | | |
|-----------------|-----------|-----------------------------|---------|
| Scale: 1:1000 | Drawn: HA | Checked: DJW | Rev: 00 |
| Date: JULY 2014 | | Drawing Ref: PD 239g | |



**PROPOSED WAITING RESTRICTIONS
AT THE JUNCTION OF COURT DRIVE
AND WADDON COURT ROAD**

CROYDON COUNCIL

EXPLODE TO EDIT FOR SCHEME TITLE

| | | | |
|--|--|---------------------------------|--|
| DEVELOPMENT AND ENVIRONMENT DEPARTMENT | | INFRASTRUCTURE - TRAFFIC DESIGN | |
| JO NEGRINI - EXECUTIVE DIRECTOR | | Checked DJW | |
| PO BOX No. 1482 | | Rev. 00 | |
| CROYDON | | Date | |
| CR9 1WX | | JULY 2014 | |
| | | Drawing Ref. PD 239q | |

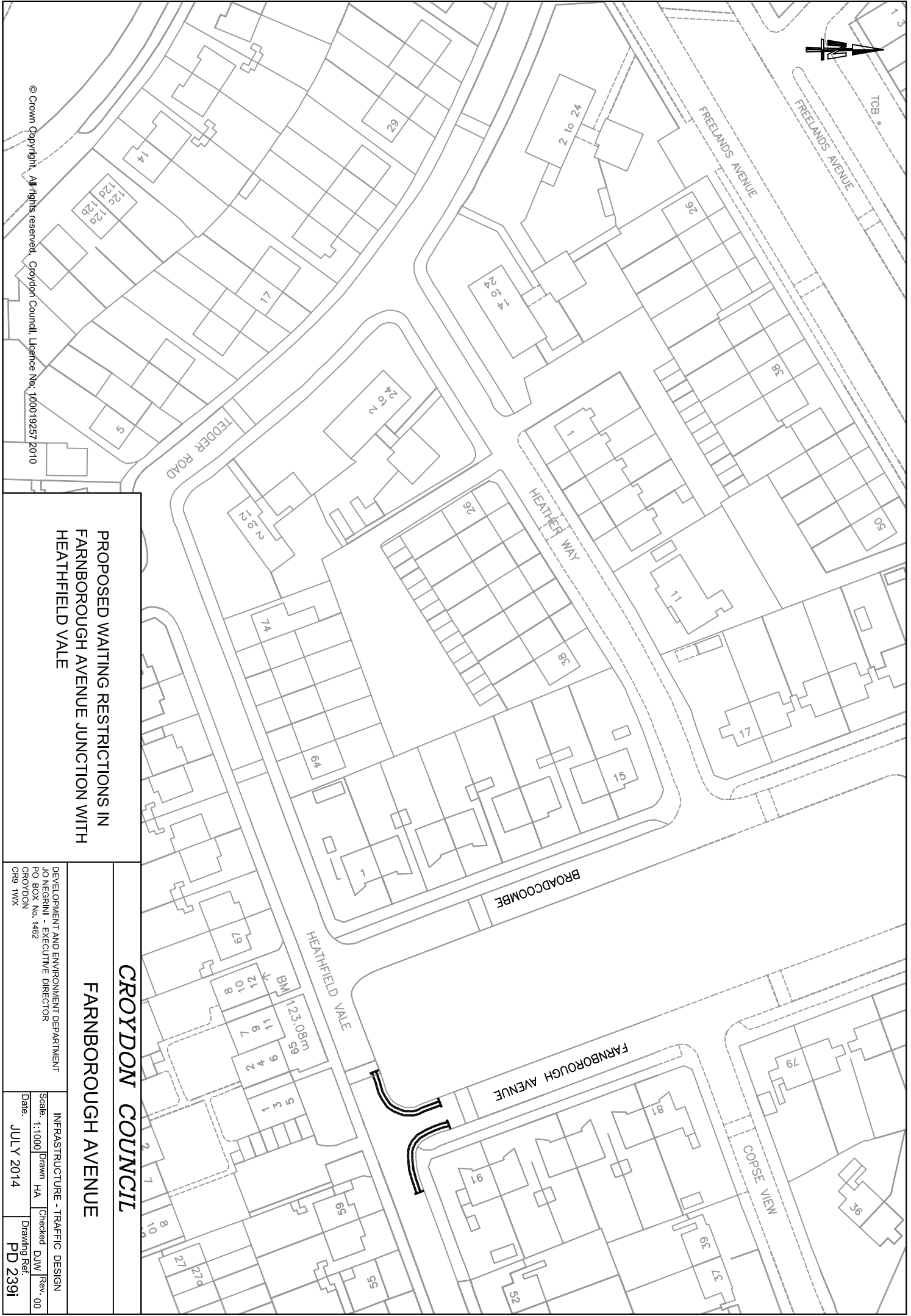

© Crown Copyright. All rights reserved. Croydon Council, Licence No. 100019257 2010

**PROPOSED WAITING RESTRICTIONS IN
FARNBOROUGH AVENUE JUNCTION WITH
HEATHFIELD VALE**

| | |
|--|----------------------|
| CROYDON COUNCIL | |
| FARNBOROUGH AVENUE | |
| DEVELOPMENT AND ENVIRONMENT DEPARTMENT | |
| JO NEGRINI - EXECUTIVE DIRECTOR | |
| PO BOX No. 1482 | |
| CROYDON | |
| CR9 1WX | |
| Scale: 1:1000 | Drawn: HA |
| Date: JULY 2014 | Checked: DJW |
| | Rev: 00 |
| | Drawing Ref: PD 2391 |



**PROPOSED EXTENSION OF "AT ANY TIME"
WAITING RESTRICTION IN HILLCOTE AVENUE**

CROYDON COUNCIL

HILLCOTE AVENUE

DEVELOPMENT AND ENVIRONMENT DEPARTMENT
 JO NAGRINI - EXECUTIVE DIRECTOR
 PO BOX No. 1482
 CROYDON
 CR9 1WX

INFRASTRUCTURE - TRAFFIC DESIGN
 Scale: 1:1000
 Date: JULY 2014
 Drawn: HA
 Checked: DJW
 Drawing Ref: PD 239K
 Rev: 00

© Crown Copyright. All rights reserved. Croydon Council, Licence No: 100019257 2010



© Crown Copyright. All rights reserved. Croydon Council, Licence No: 100019257 2010

**PROPOSED WAITING RESTRICTION
OUTSIDE No. 2 LODGE AVENUE**

CROYDON COUNCIL

LODGE AVENUE

DEVELOPMENT AND ENVIRONMENT DEPARTMENT
JO NAGRINI - EXECUTIVE DIRECTOR
PO BOX No. 1462
CROYDON
CR9 1WX

| | | | |
|---------------------------------|-----------|------------|----------------------|
| INFRASTRUCTURE - TRAFFIC DESIGN | | | |
| Scale: 1:1000 | Drawn HA | Checked DW | Rev. 00 |
| Date: | JULY 2014 | | Drawing Ref. PD 239r |



© Crown Copyright. All rights reserved. Croydon Council, Licence No: 100019257 2010

**PROPOSED "AT ANY TIME" WAITING RESTRICTIONS
IN MITCHAM ROAD / ROCHFORD ROAD**

CROYDON COUNCIL

MITCHAM ROAD / ROCHFORD ROAD

DEVELOPMENT AND ENVIRONMENT DEPARTMENT
JO NEGRINI - EXECUTIVE DIRECTOR
PO BOX No. 1462
CROYDON
CR9 1WX

| | | | |
|---------------------------------|----------------------|-------------|---------|
| INFRASTRUCTURE - TRAFFIC DESIGN | | | |
| Scale: 1:500 | Drawn HA | Checked DJW | Rev. 00 |
| Date: JULY 2014 | Drawing Ref. PD 239c | | |

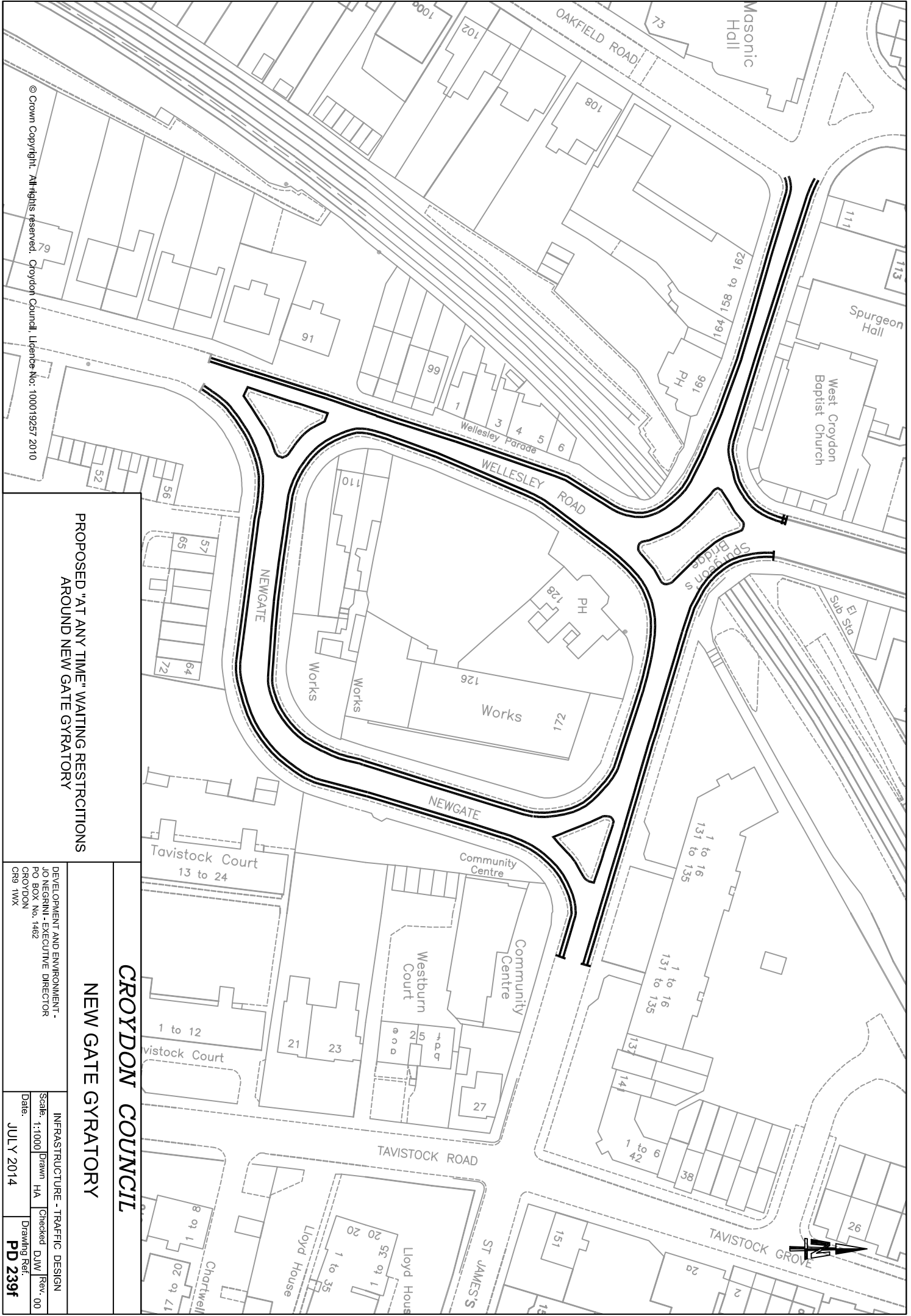

© Crown Copyright. All rights reserved. Croydon Council. Licence No: 100019257 2010

**PROPOSED "AT ANY TIME" WAITING RESTRICTIONS
AROUND NEW GATE GYRATORY**

| | |
|---|-----------------------------|
| CROYDON COUNCIL | |
| NEW GATE GYRATORY | |
| DEVELOPMENT AND ENVIRONMENT - JO NEGRINI - EXECUTIVE DIRECTOR PO BOX No. 1482 CROYDON CR9 1WX | |
| Scale: 1:1000 | Drawn: HA |
| Date: JULY 2014 | Checked: DJW |
| | Rev: 00 |
| | Drawing Ref: PD 239f |



Allotment Gardens

**PROPOSED WAITING RESTRICTION
IN PAMPISFORD ROAD**

CROYDON COUNCIL
PAMPISFORD ROAD

© Crown Copyright. All rights reserved. Croydon Council. Licence No: 100019257/2010

| | | | |
|--|--|---------------------------------|----------------|
| DEVELOPMENT AND ENVIRONMENT DEPARTMENT | | INFRASTRUCTURE - TRAFFIC DESIGN | |
| JO NEGRINI - EXECUTIVE DIRECTOR | | Scale: 1:1000 | |
| PO BOX No. 1462 | | Drawn | HW |
| CROYDON | | Checked | DJW |
| CR9 1WX | | Date: | Rev: 00 |
| | | JULY 2014 | Drawing Ref: |
| | | | PD 239s |

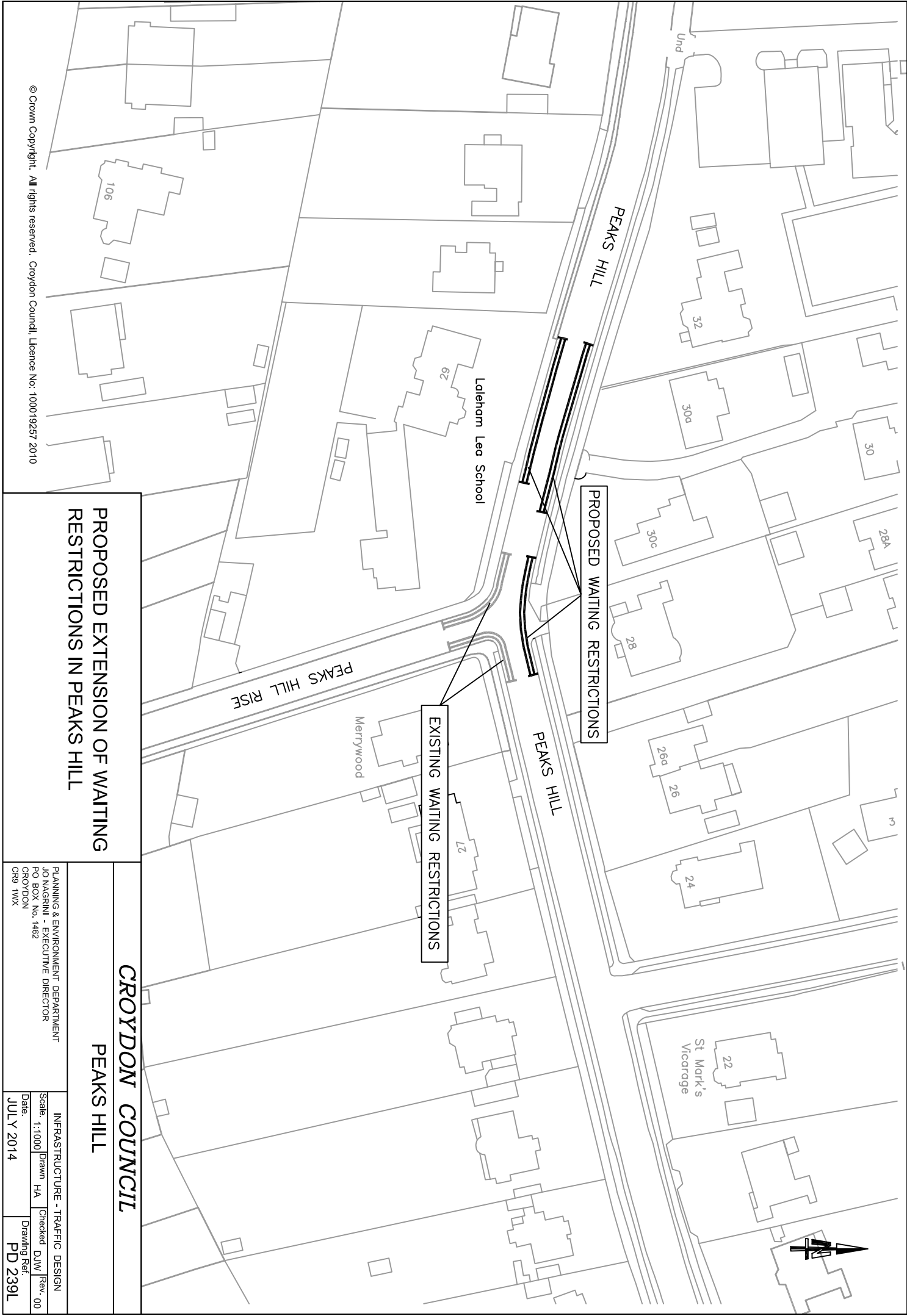

PROPOSED WAITING RESTRICTIONS

EXISTING WAITING RESTRICTIONS

PROPOSED EXTENSION OF WAITING RESTRICTIONS IN PEAKS HILL

CROYDON COUNCIL

PEAKS HILL

PLANNING & ENVIRONMENT DEPARTMENT
 JO NAGRINI - EXECUTIVE DIRECTOR
 PO BOX No. 1482
 CROYDON
 CR9 1WX

INFRASTRUCTURE - TRAFFIC DESIGN
 Scale: 1:1000
 Date: JULY 2014
 Drawn: HA
 Checked: DJW
 Rev: 00
 Drawing Ref: PD 239L

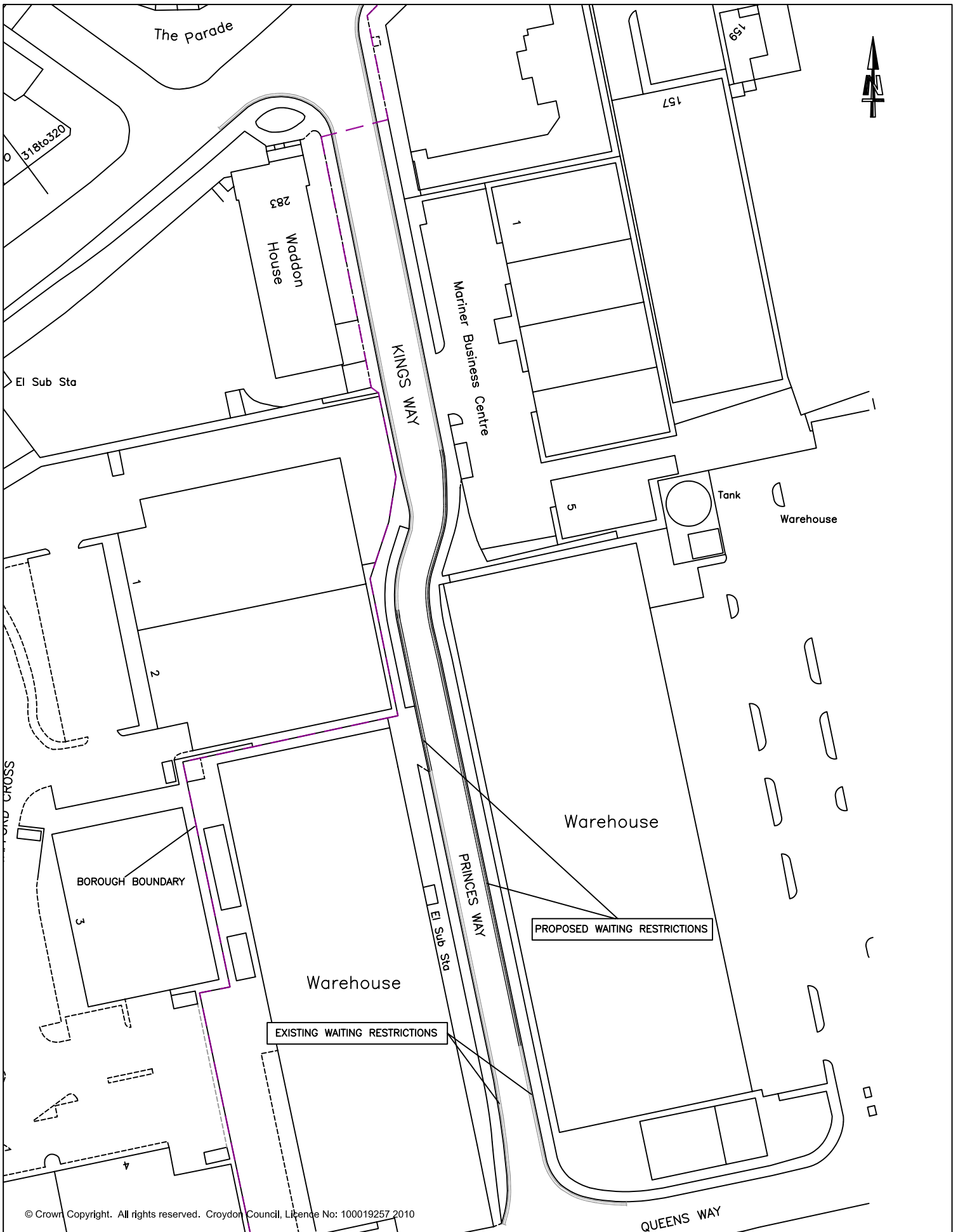

© Crown Copyright. All rights reserved. Croydon Council, Licence No: 100019257 2010

PROPOSED EXTENSION OF EXISTING WAITING RESTRICTIONS IN PRINCES WAY

CROYDON COUNCIL

PRINCES WAY

DEVELOPMENT AND ENVIRONMENT DEPARTMENT
 JO NEGRINI - EXECUTIVE DIRECTOR
 PO BOX No. 1462
 CROYDON
 CR9 1WX

| | | | |
|---------------------------------|-----------|-------------|-----------------------------|
| INFRASTRUCTURE - TRAFFIC DESIGN | | | |
| Scale: 1:1000 | Drawn HA | Checked DJW | Rev. 00 |
| Date: | JULY 2014 | | Drawing Ref. PD 239t |



© Crown Copyright. All rights reserved. Croydon Council. Licence No: 100019257 2010



CROYDON COUNCIL

SISSINGHURST ROAD / WYDEHURST ROAD - CROYDON
Proposed "At Any Time" Waiting Restrictions

| | | | |
|--------------------------------------|--|---------------------------------|--|
| DEVELOPMENT & ENVIRONMENT DEPARTMENT | | INFRASTRUCTURE - TRAFFIC DESIGN | |
| JO NAGRINI - EXECUTIVE DIRECTOR | | Checked DJW | |
| PO BOX No. 1482 | | Rev. 00 | |
| CROYDON | | Drawing Ref. PD 239b | |
| CR9 1WX | | Date: JULY 2014 | |

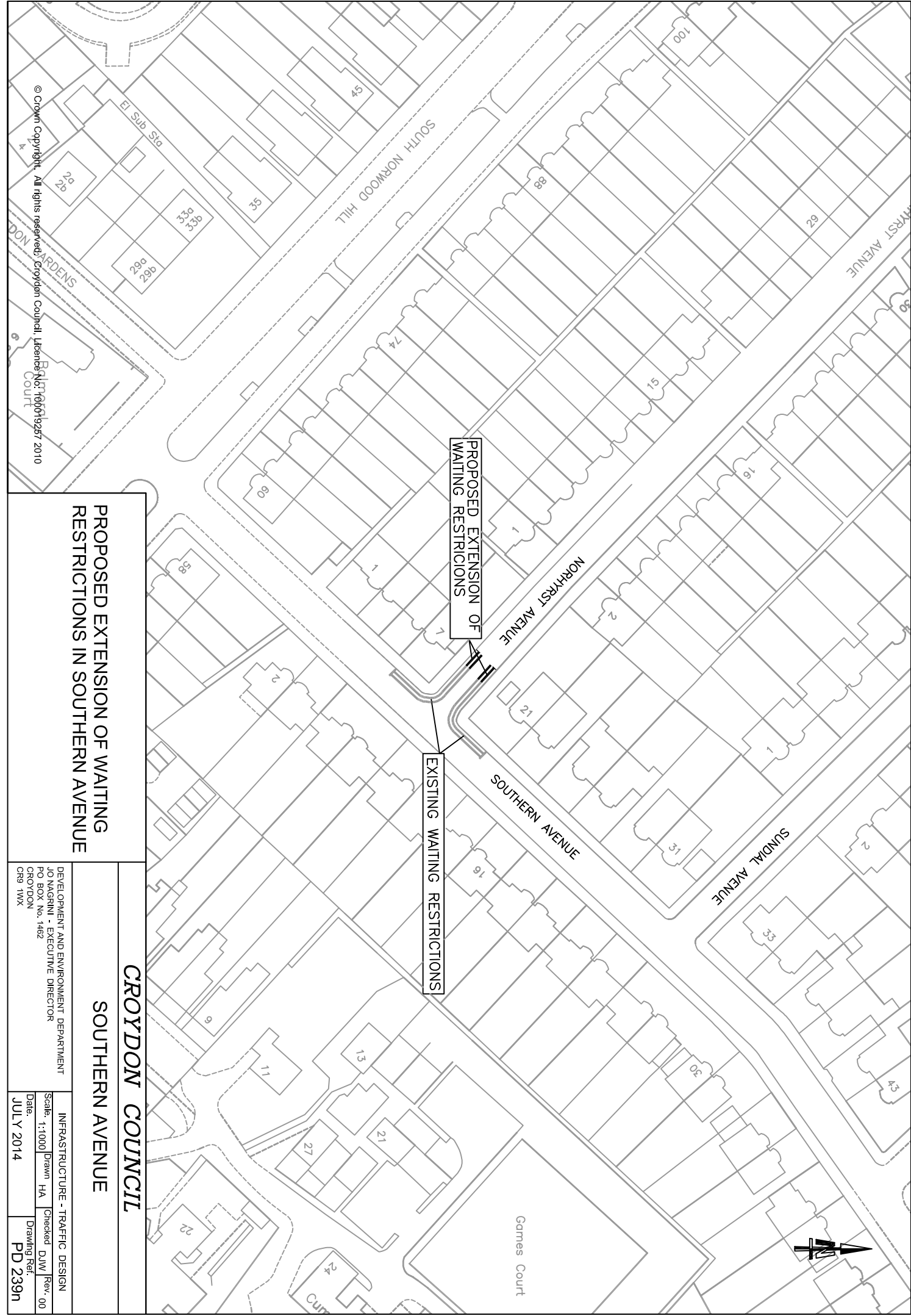

PROPOSED EXTENSION OF WAITING RESTRICTIONS

EXISTING WAITING RESTRICTIONS

PROPOSED EXTENSION OF WAITING RESTRICTIONS IN SOUTHERN AVENUE

CROYDON COUNCIL
SOUTHERN AVENUE

DEVELOPMENT AND ENVIRONMENT DEPARTMENT
JO NAGRINI - EXECUTIVE DIRECTOR
PO BOX No. 1482
CROYDON
CR9 1WX

INFRASTRUCTURE - TRAFFIC DESIGN
Scale: 1:1000
Date: JULY 2014
Drawn: HA
Checked: DJW
Rev: 00
Drawing Ref: PD 239n

© Crown Copyright. All rights reserved. Croydon Council. Licence No: 100019257 2010

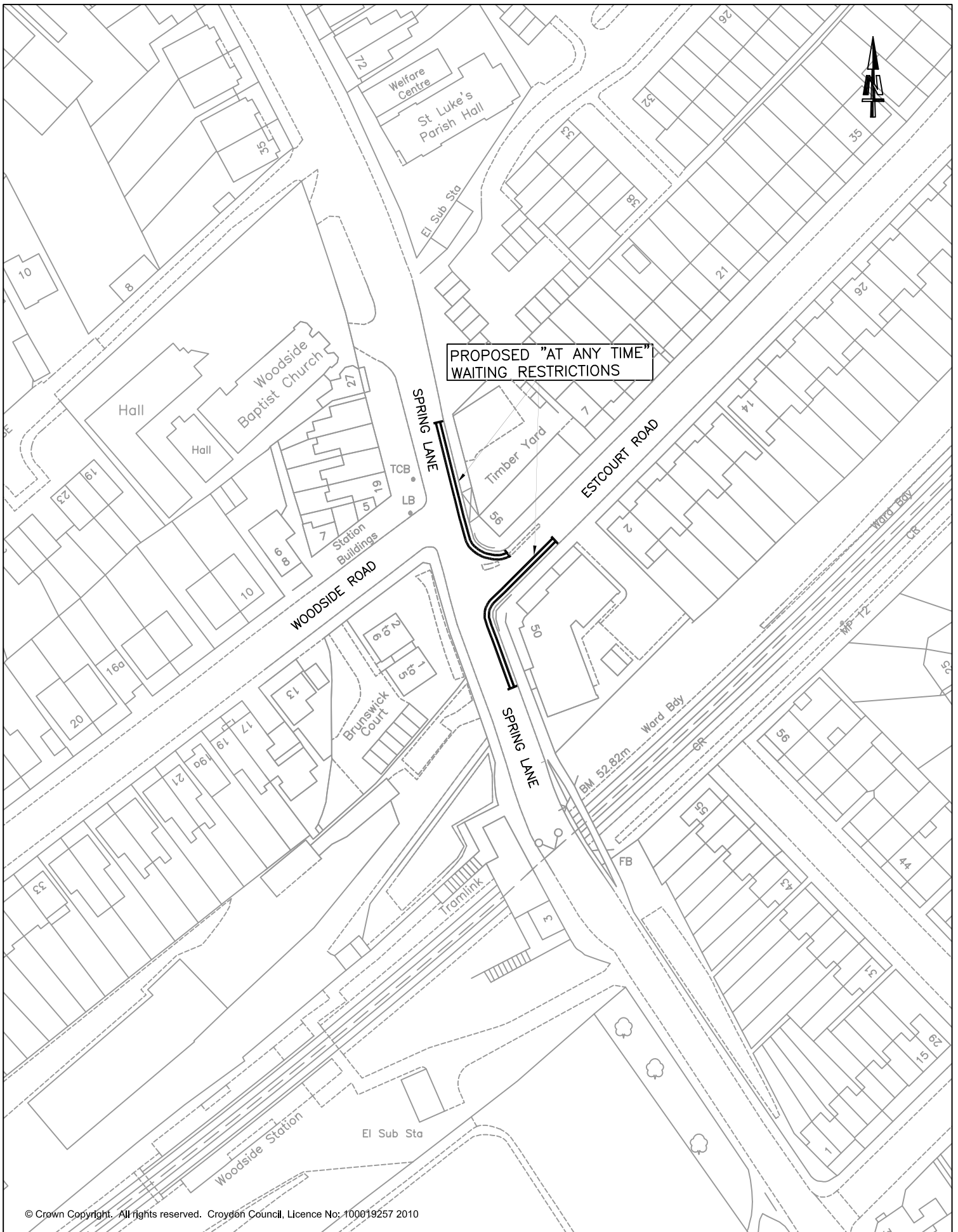

PROPOSED "AT ANY TIME"
WAITING RESTRICTIONS

© Crown Copyright. All rights reserved. Croydon Council, Licence No: 100019257 2010

**PROPOSED WAITING RESTRICTIONS
IN SPRING LANE AND ESTCOURT ROAD**

CROYDON COUNCIL

SPRING LANE BY ESTCOURT ROAD

DEVELOPMENT AND ENVIRONMENT DEPARTMENT
JO NAGRINI - EXECUTIVE DIRECTOR
PO BOX No. 1462
CROYDON
CR9 1WX

| | | | |
|---------------------------------|-----------|------------|-------------------------|
| INFRASTRUCTURE - TRAFFIC DESIGN | | | |
| Scale: 1:1000 | Drawn HA | Checked DW | Rev. 00 |
| Date: | JULY 2014 | | Drawing Ref. PD 239x |



© Crown Copyright. All rights reserved. Croydon Council, Licence No: 100019257 2010

PROPOSED WAITING RESTRICTION AT THE JUNCTION OF SUFFOLK RD WITH ST DUNSTAN'S ROAD

| | |
|--|----------------------|
| CROYDON COUNCIL | |
| St DUNSTAN'S RD / SUFFOLK RD | |
| DEVELOPMENT AND ENVIRONMENT DEPARTMENT | |
| JO NAGRINI - EXECUTIVE DIRECTOR | |
| PO BOX No. 1482 | |
| CROYDON | |
| CR9 1WX | |
| Scale: 1:1000 | Drawn: HA |
| Date: JULY 2014 | Checked: DJW |
| | Rev: 00 |
| | Drawing Ref: PD 239p |

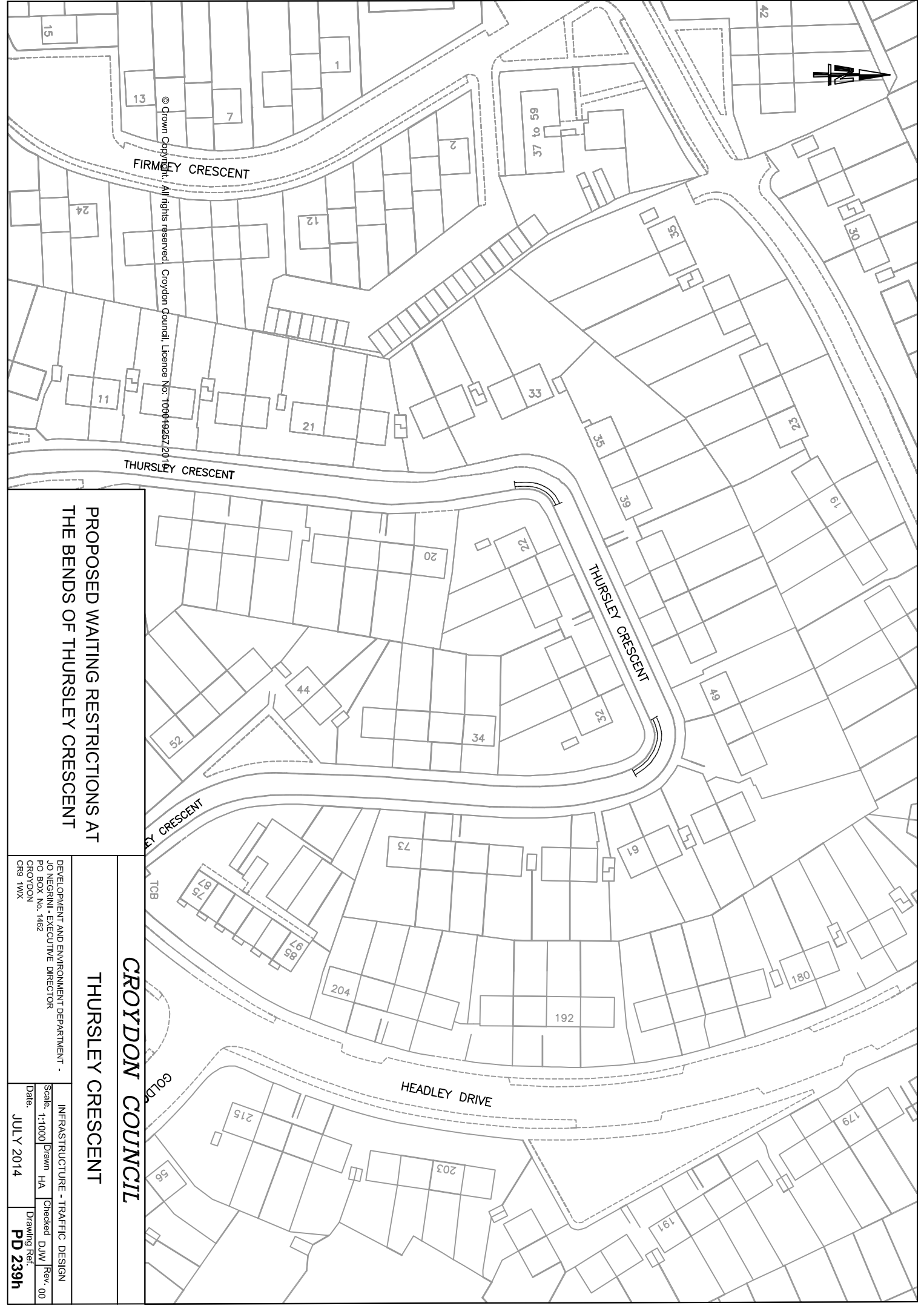

© Crown Copyright. All rights reserved. Croydon Council. Licence No: 100049257/2014

**PROPOSED WAITING RESTRICTIONS AT
THE BENDS OF THURSLEY CRESCENT**

**CROYDON COUNCIL
THURSLEY CRESCENT**

DEVELOPMENT AND ENVIRONMENT DEPARTMENT -
JO NEGRINI - EXECUTIVE DIRECTOR
PO BOX No. 1482
CROYDON
CR9 1WX

INFRASTRUCTURE - TRAFFIC DESIGN
Scale: 1:1000
Date: JULY 2014
Drawing Ref: PD 239h

Drawn: HA
Checked: DJW
Rev: 00

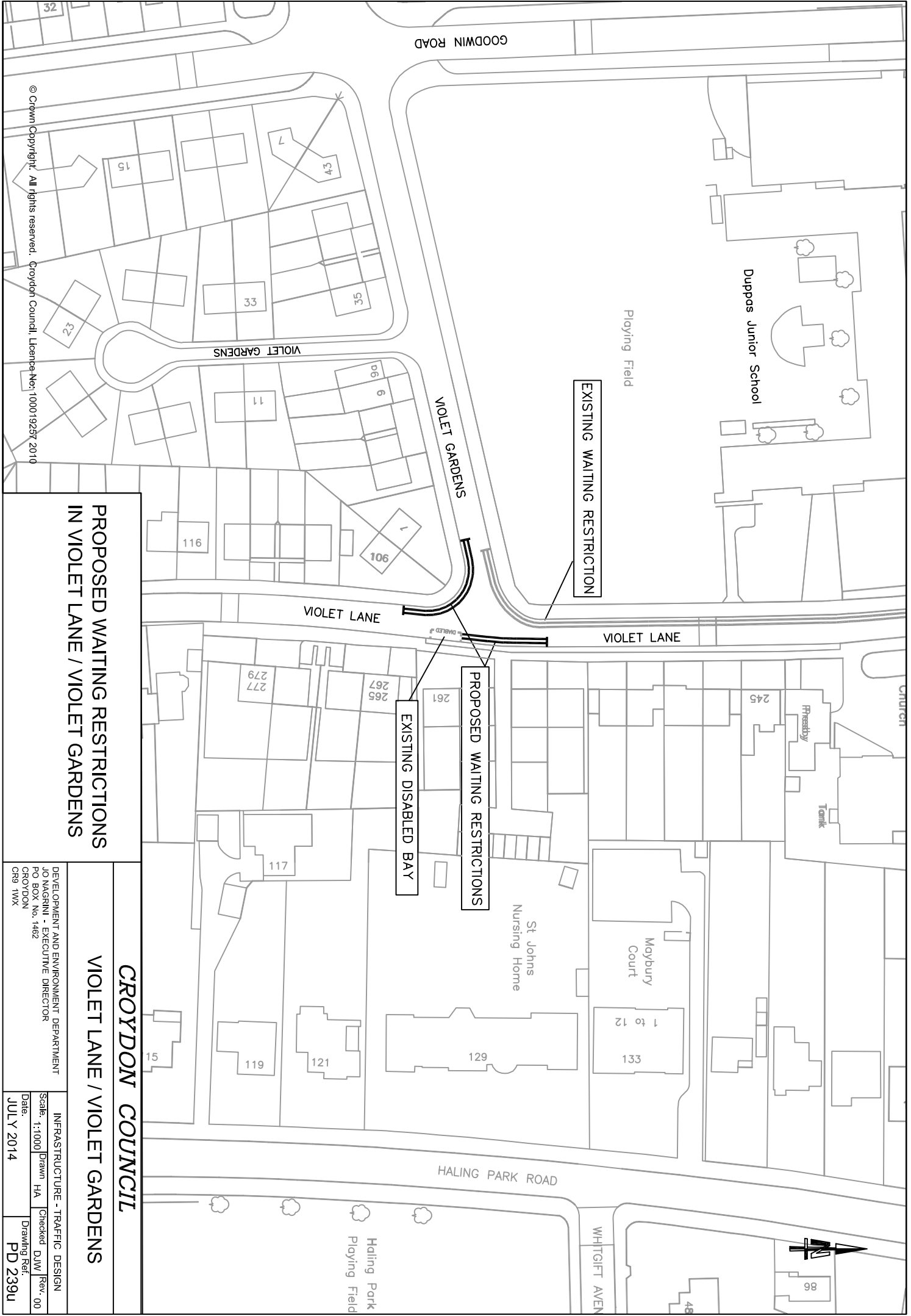

**PROPOSED WAITING RESTRICTIONS
IN VIOLET LANE / VIOLET GARDENS**

CROYDON COUNCIL

VIOLET LANE / VIOLET GARDENS

DEVELOPMENT AND ENVIRONMENT DEPARTMENT
 JO NAGRINI - EXECUTIVE DIRECTOR
 PO BOX No. 1482
 CROYDON
 CR9 1WX

INFRASTRUCTURE - TRAFFIC DESIGN
 Scale: 1:1000
 Date: JULY 2014
 Drawn: HA
 Checked: DJW
 Rev: 00
 Drawing Ref: PD 239U

© Crown Copyright. All rights reserved. Croydon Council, Licence No: 100019257 2010

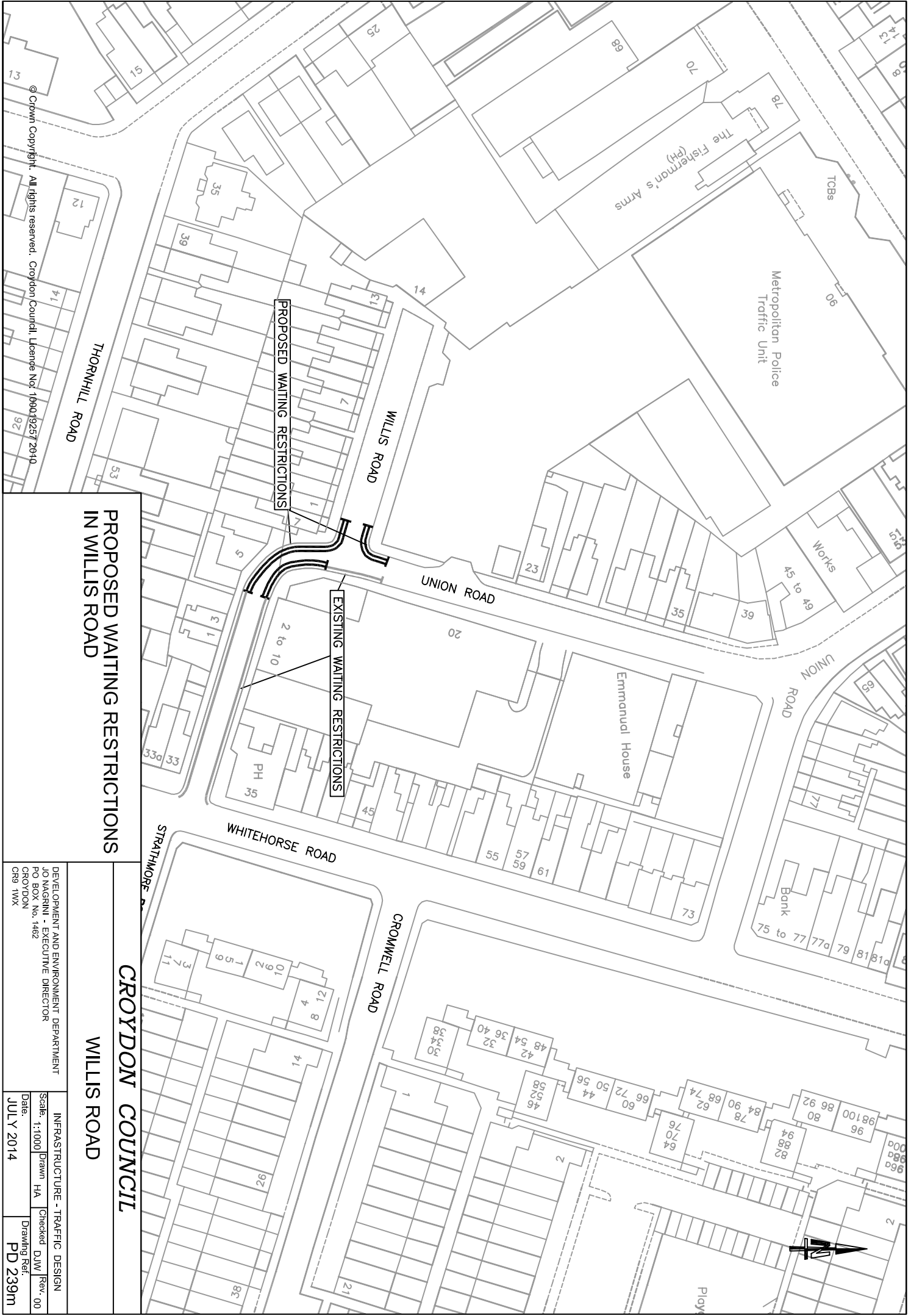

**PROPOSED WAITING RESTRICTIONS
IN WILLIS ROAD**

CROYDON COUNCIL

WILLIS ROAD

| | | | |
|--|--|---------------------------------|----------------------|
| DEVELOPMENT AND ENVIRONMENT DEPARTMENT | | INFRASTRUCTURE - TRAFFIC DESIGN | |
| JO NAGRINI - EXECUTIVE DIRECTOR | | Scale: 1:1000 | Drawn: HA |
| PO BOX No. 1482 | | Date: JULY 2014 | Checked: DJW |
| CROYDON | | | Rev: 00 |
| CR9 1WX | | | Drawing Ref: PD 239m |

© Crown Copyright. All rights reserved. Croydon Council, Licence No: 100019257/2010



CF
Word Bdy

PROPOSED "AT ANY TIME"
WAITING RESTRICTIONS

EXISTING CONTROL PARKING BAY

EXISTING WAITING RESTRICTIONS

WOODCOTE VALLEY ROAD

MONAHAN AVENUE

WOODCOTE VALLEY ROAD

PURLEY KNOLL

BOX RIDGE
AVENUE

UPGRADE EXISTING WAITING RESTRICTION
(1pm - 2pm, Mon to Fri) to "AT ANY TIME" OPPOSITE
St. DAVID'S SCHOOL IN WOODCOTE VALLEY ROAD
WOODCOTE VALLEY ROAD

CROYDON COUNCIL

WOODCOTE VALLEY ROAD

| | | | |
|--|--|---------------------------------|-----------|
| DEVELOPMENT AND ENVIRONMENT DEPARTMENT | | INFRASTRUCTURE - TRAFFIC DESIGN | |
| JO NEGRINI - EXECUTIVE DIRECTOR | | Drawn | HA |
| PO BOX No. 1482 | | Checked | DJW |
| CROYDON | | Rev | 00 |
| CR9 1WX | | Date | JULY 2014 |
| | | Drawing Ref | PD 239d |